



Live amidst beauty and serenity.





It's a destination everybody will want to go to - Baddi. It is a fast growing town in Himachal Pradesh, close to Chandigarh which is witnessing a remarkable increase in the number of people settling down there. Keeping this in mind, OMAXE has brought to you **OMAXE PARK WOODS**, a housing project in this picturesque setting of Himachal Pradesh offering you a perfect opportunity to live a peaceful and serene life. What's more, with 1/2/3 bedroom apartments, OMAXE PARK WOODS can also turn into a means for possible rental income with low investment, given the popularity of the place.





Omaxe Park Woods is ready for people to move in right away and the township is replete with all modern amenities offering a modern day lifestyle along with the surrounding natural beauty.

350 FAMILIES ALREADY LIVING



PERSPECTIVE VIEW



ACTUAL VIEW



ACTUAL VIEW



ACTUAL VIEW



OMAXE

Park Woods

Baddi, Himachal Pradesh

Near Chandigarh

Club at Park Woods, Baddi

OMAXE PARK WOODS- AT A GLANCE

Over 350 families already residing

Gated Complex

24 hours water supply

Club with all modern amenities

Beautiful landscaping and water bodies

Located in the heart of city

Shopping complex in the society

Dedicated parking space



At Omaxe Park Woods, everything is catered for, whether it is a cool dip in a swimming pool that you are looking for, some shopping indulgence, going on a cycling spree to stay fit or a bit of Yoga, the township has it all.





PERSPECTIVE VIEW

SPECIFICATIONS (w.e.f. 01/12/2013)

Structure	Earthquake resistant RCC	Wall finishing	Internal wall plastered and painted with pleasing shades of Oil bound distemper
External finishing	Long lasting paint (Rustic)	Windows	Power coated Aluminium Window
Bedroom	*Wardrobe and Fans in each Bedroom	Electrical	Concealed Copper wiring, provision for lights, plug points in each bedroom, D/D & Lounge, *Decorative Lights & Fittings including Chandelier.
Toilet walls	Dado upto 7'-0" height of glazed ceramic tiles	Flooring	Vitrified tiles in all bedrooms and DD
Bathroom	*Geysers in each Bathroom	Doors	Hardwood framed & flush doors
Toilet fitting	Wash Basin,EWC, Provision for hot & cold water system	Staircase	Combination of Udaipur green & marble
Kitchen	Green Marble with stainless steel sink. Dado up to 2'-0" above platform in ceramic / glazed tiles, *Modular Kitchen cabinet with chimney		

Gulmohar

2 Bedroom Unit
Super Area = 1250 Sq. Ft.

Floor Plan



1 Sq. Mtr. = 10.764 sq. ft.

Gulmohar

2 Bedroom Cluster
Typical Floor Plan

Cluster Plan



1 Sq. Mtr. = 10.764 sq. ft.

Kachnar

2 Bedroom Unit
Super Area = 1035 Sq. Ft.

Floor Plan



1 Sq. Mtr. = 10.764 sq. ft.

Kachnar

2 Bedroom Cluster
Typical Floor Plan

Cluster Plan

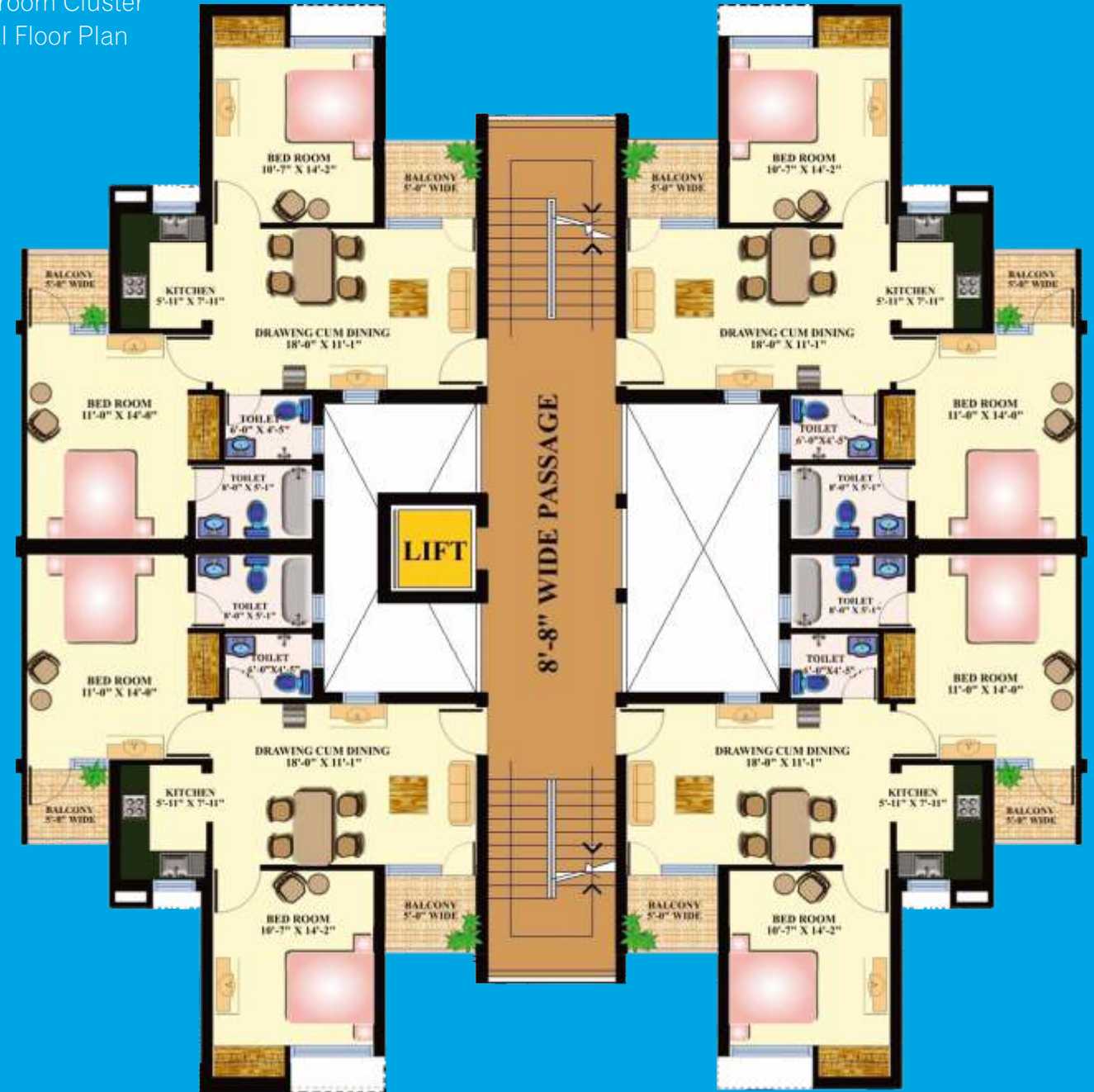

1 Sq. Mtr. = 10.764 sq. ft.

Jacaranda

1 Bedroom Unit
Super Area = 779 Sq. Ft.

Floor Plan



1 Sq. Mtr. = 10.764 sq. ft.

Jacaranda

1 Bedroom Cluster
Typical Floor Plan

Cluster Plan

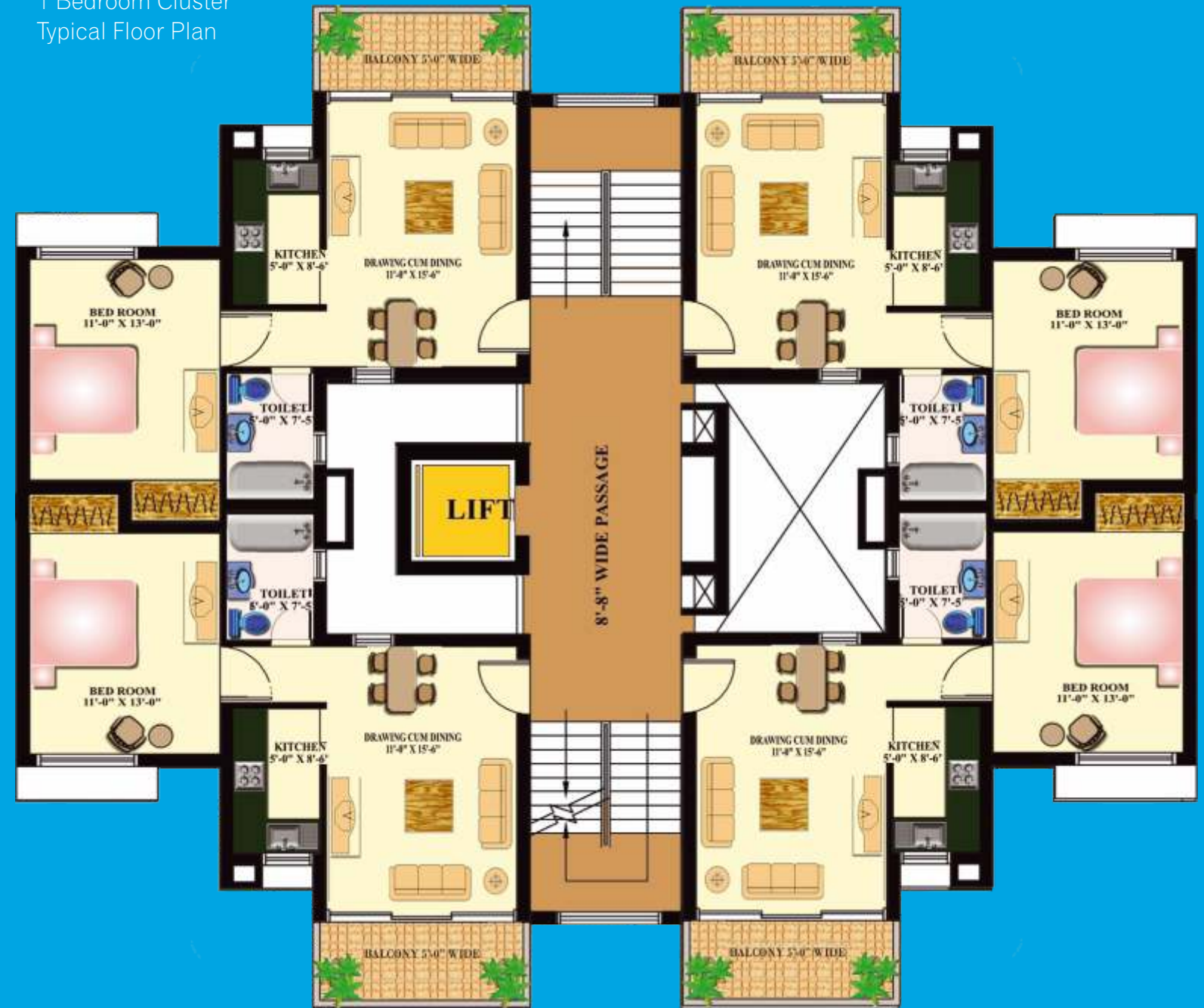

1 Sq. Mtr. = 10.764 sq. ft.

Master Layout Plan

- CHINAR (3 BEDROOM) TYPE-C: 1649 sq.ft.
- GULMOHAR (2 BEDROOM) TYPE-B2: 1250 sq.ft.
- KACHNAR (2 BEDROOM) TYPE-A: 1035 sq.ft.
- JACARANDA (1 BEDROOM) TYPE-B1: 779 sq.ft.
- EWS



Location Map - Omaxe Park Woods, Baddi



DISTANCE CHART		
CHANDIGARH	:	23 KM
NEW CHANDIGARH	:	22 KM
PANCHKULA	:	30 KM
PINJORE	:	17 KM
NALAGARH	:	17 KM
SAI ROAD	:	0.5 KM
BADDI BUS STAND	:	2 KM
KALKA	:	23 KM
SHIMLA	:	100 KM

Map not to scale